

Regatta™ Tabletop Display

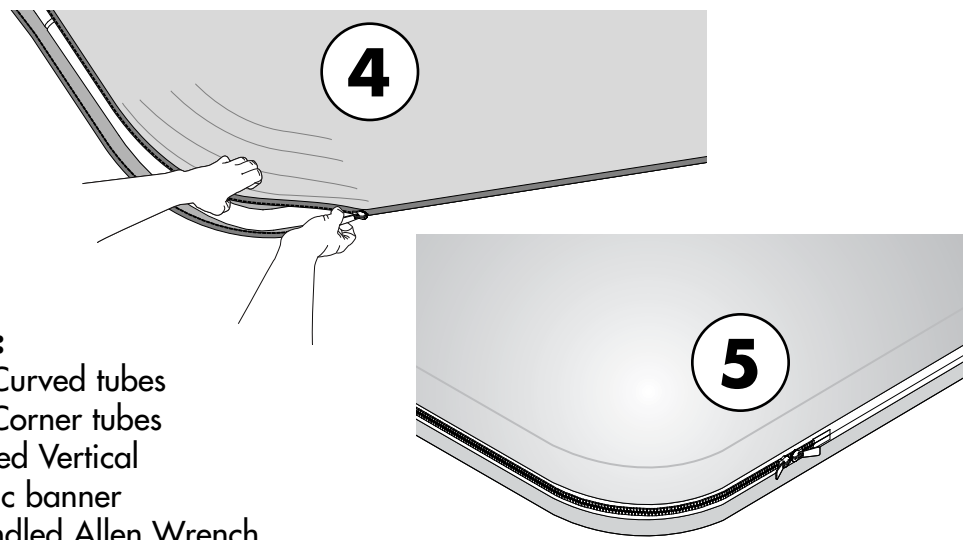

- Part List:**
- 2 90° Curved tubes
 - 4 90° Corner tubes
 - 1 Curved Vertical
 - 1 Fabric banner
 - 1 T-handled Allen Wrench

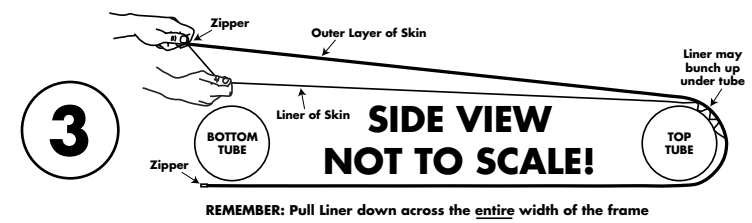
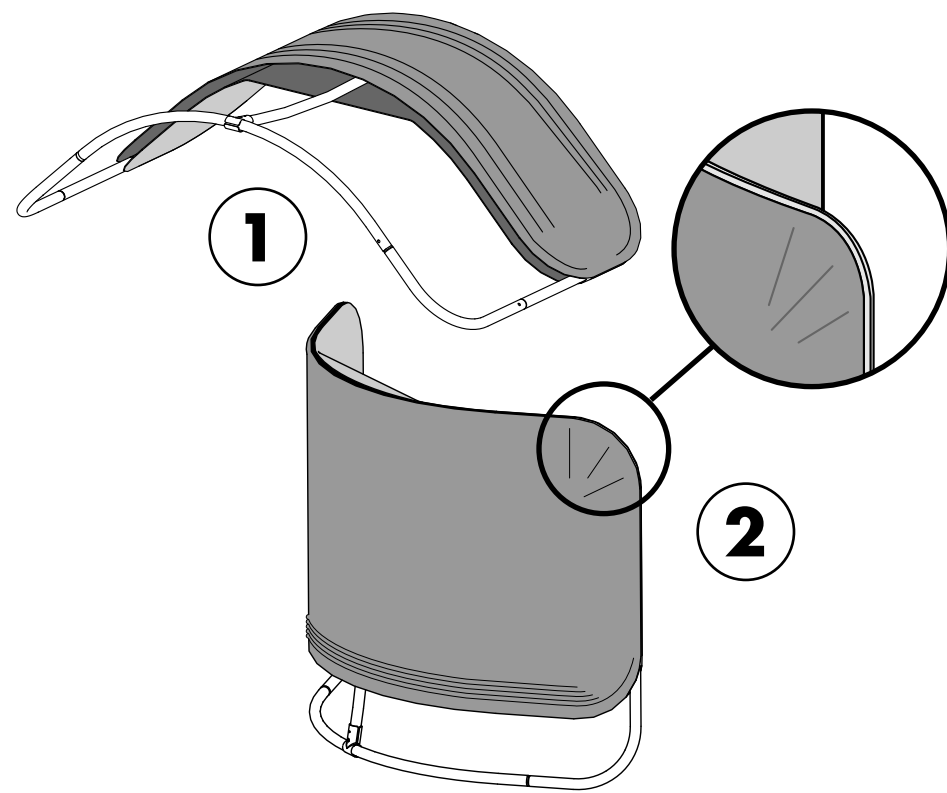
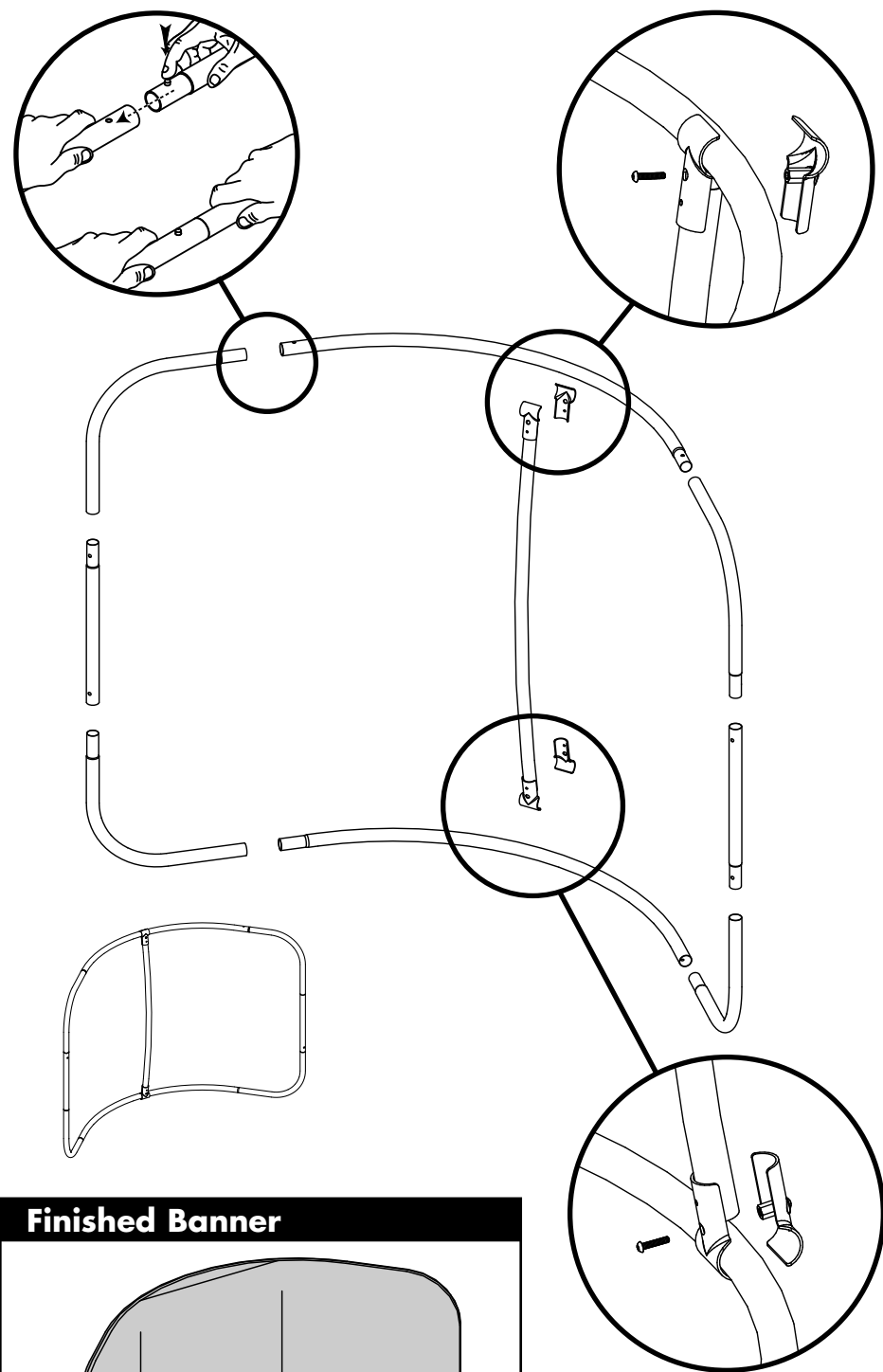
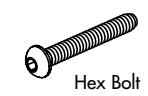

Assembly Instructions

Set the frame upright so you can lay a plastic sheet on the floor to protect the fabric cover when installing.

1. Lay the frame down on top of the plastic with convex side up. Remove the fabric cover from the nylon storage bag, unzip the cover and spread it out on the floor. The liner side of the cover goes on the convex side of the frame. Slide pillowcase-like cover over the frame about half way.

2. Stand the frame up and the cover will easily slide down over the frame. Fit the top corners tightly on the frame.
Lay the frame back down convex side up.

3. The black liner piece can get caught on the top of the frame. Separate the liner from the fabric graphic and pull it down all along the width of the bottom edge.

4. Fit the bottom cover corners on the frame. Start zipping one side around its corner as far as the first tube joint. Move to the second corner and zip it to the first joint as well. If you have trouble getting the second zipper started, pull the fabric down from the top of the frame along that edge. The fabric can get somewhat twisted when the first corner gets zipped.

Continue zipping the rest of the cover. One person can do this but it is easier to have one person pull up the concave side of the fabric cover which has no liner and will stretch more, and the other do the zipping. Pull fabric about 6" ahead of the zipper pull.

5. When you have finished the zipping and they both meet in the center, move both zipper pulls around to one side to they do not interfere when the structure is standing.

Stand the finished structure upright and go around the frame and align the edge seams of the banner with the frame to improve the look of the graphic.

Note: The top seam is finished with 3 button holes for future light application and the bottom with one button hole for the lighting cord.